



OXFORD STREET  
LONDON

	sq ft	sq m
Unit 1	1,812	168
Unit 2	2,319	215
Unit 3	2,132	198
Unit 4	5,536	514
Unit 5	Boom: Battle Bar	
<b>Total</b>	<b>11,799</b>	<b>1,095</b>

 Potential lift location

# GROUND FLOOR



  
Tottenham Court Road Station  
entrance at Dean Street



	sq ft	sq m
Unit 1	3,158	293
Unit 2	1,887	175
Unit 3	2,221	206
Unit 4	6,197	576
Unit 5	Boom: Battle Bar	
<b>Total</b>	<b>13,463</b>	<b>1,250</b>

 Potential lift location

# FIRST FLOOR



# LOWER GROUND FLOOR

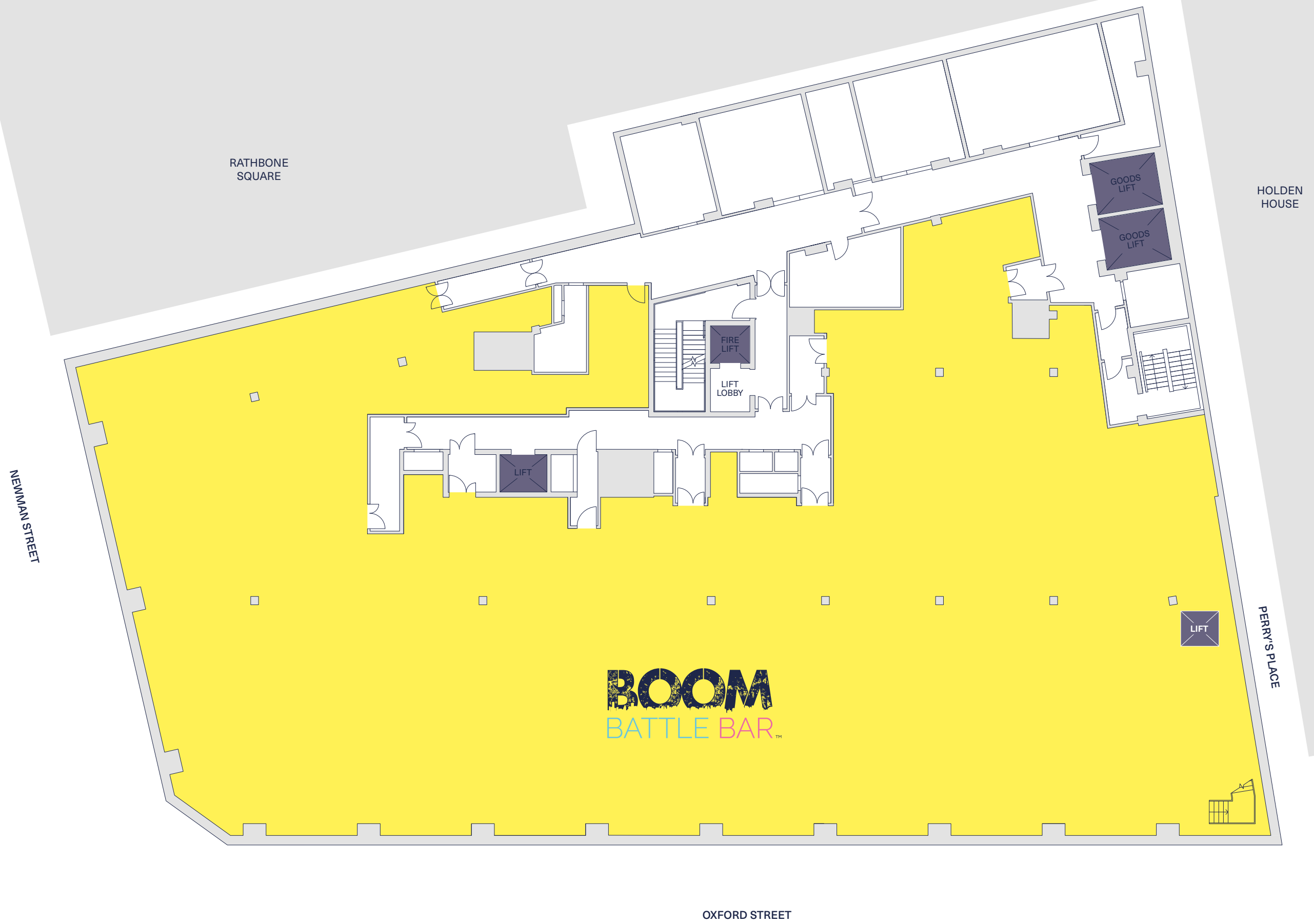



OXFORD STREET  
LONDON