



OXFORD STREET
LONDON

	sq ft	sq m
Unit 1	1,812	168
Unit 2	2,319	215
Unit 3	2,132	198
Unit 4	5,536	514
BBB	427	40
Total	12,226	1,135

 Potential lift location

GROUND FLOOR



Tottenham Court Road Station
entrance at Dean Street



	sq ft	sq m
Unit 1	3,158	293
Unit 2	1,887	175
Unit 3	2,221	206
Unit 4	6,197	576
BBB	117	11
Total	13,580	1,261

 Potential lift location

FIRST FLOOR

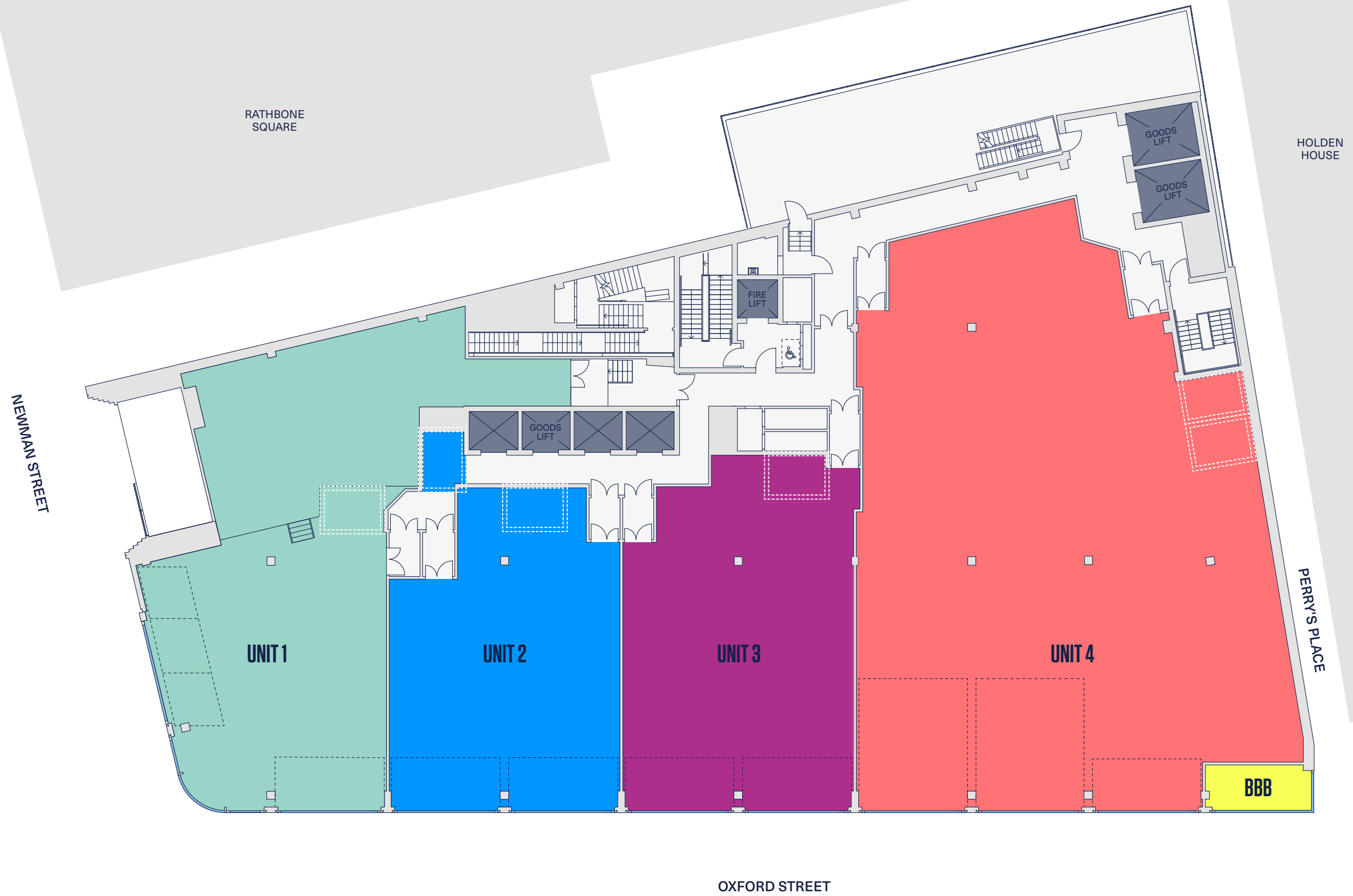

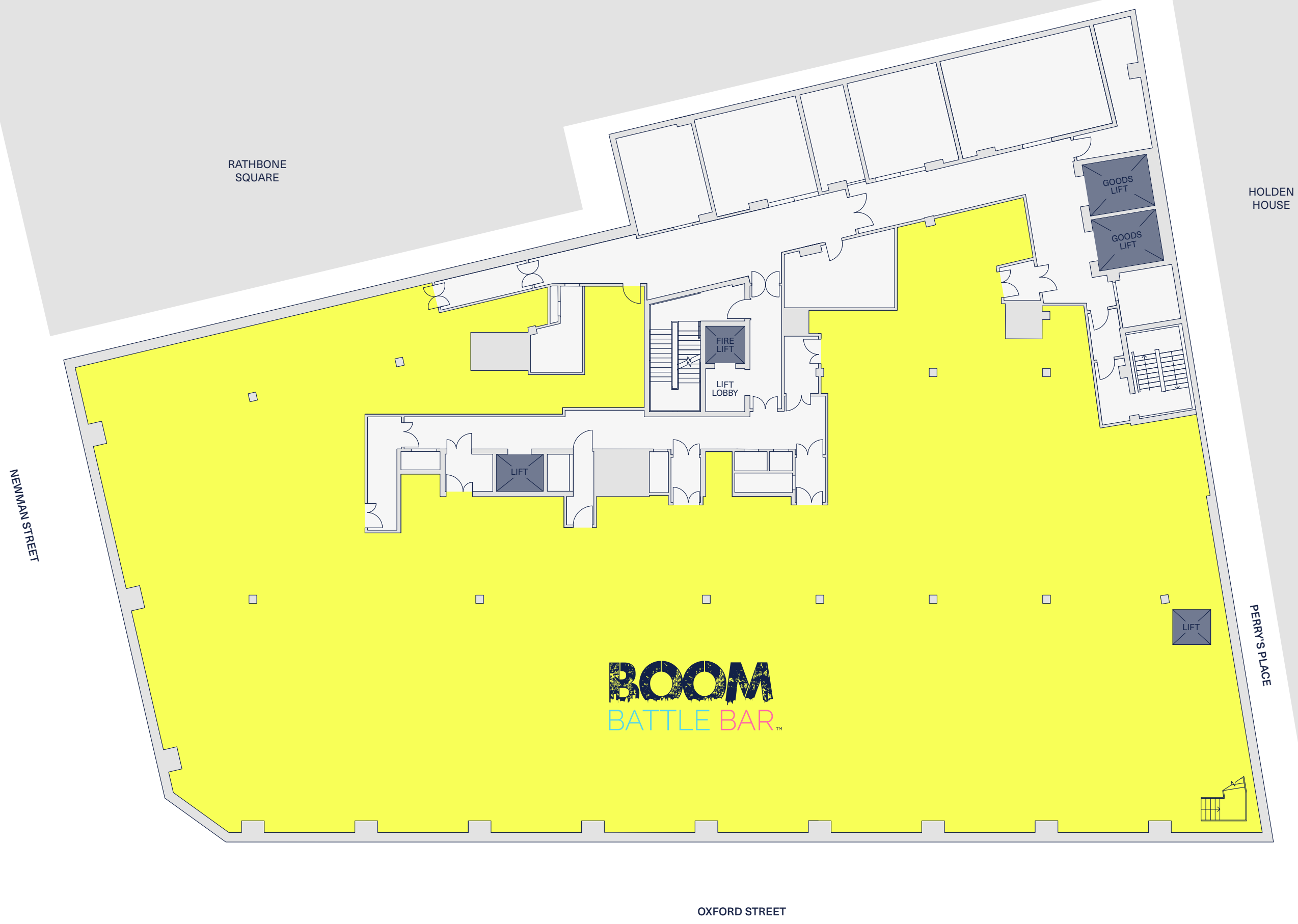

	sq ft	sq m
BBB	14,763	1,371
Total	14,763	1,371

LOWER GROUND FLOOR





OXFORD STREET
LONDON

